

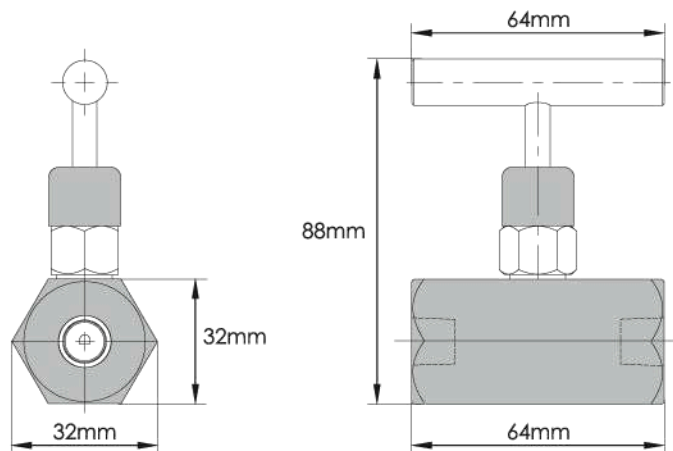

## FCV SERIES



CVN1 and CVN3



CVC3

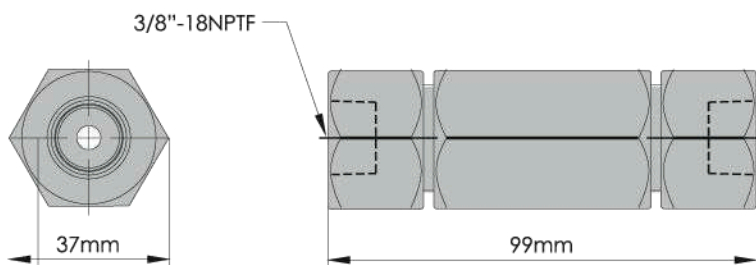

CVP3

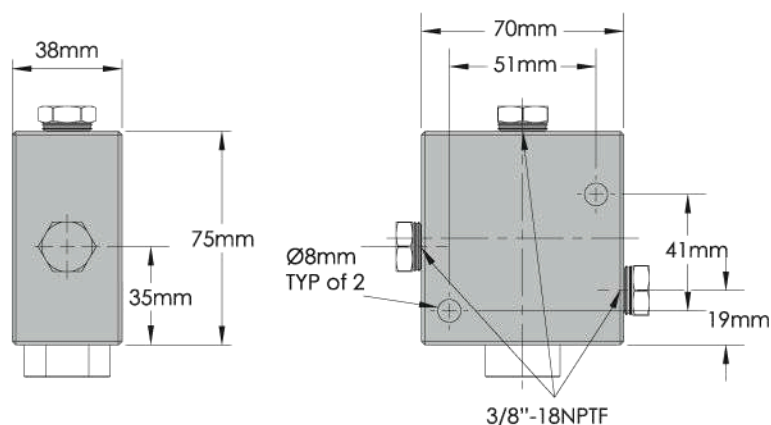

MODEL	Valve Type	Ports	Applications	Hydraulic Symbol
CVN1	Needle Valve	1/4"-18NPTF	Controls cylinder speed and acts as temporary shut-off valve for load holding.	
CVN3		3/8"-18NPTF		
CVC3	Check Valve	3/8"-18NPTF	Allows flow in one direction only.	
CVP3	Pilot Operated Check Valve	3/8"-18NPTF	Mounted in line with a cylinder which will hold pressure in the event of pressure loss in the system. Most often used on double-acting cylinders with pilot port, receiving pressure from a tee off of the cylinder retracting line. Pilot pressure ratio 15% or 6.5:1	



**CVR3**

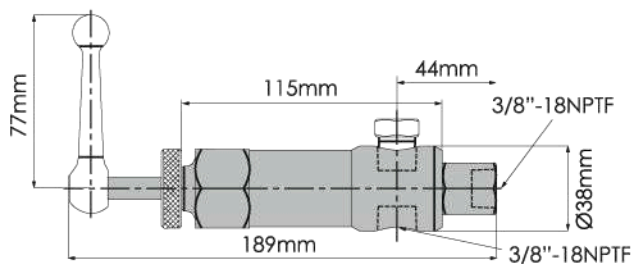

**CVL3**

3/8"-18NPTF  
Ø8mm  
TYP of 2

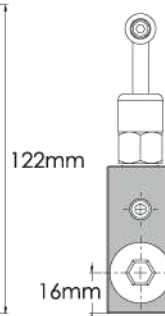
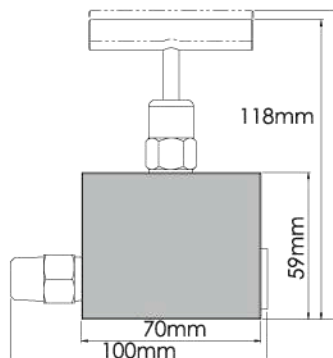
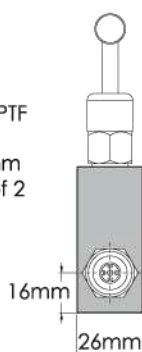

**CVLS3**

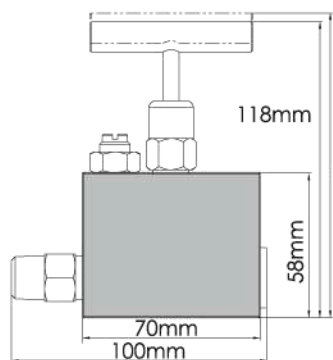
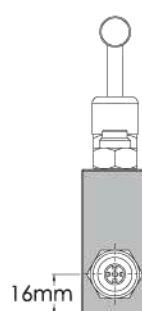

MODEL	Valve Type	Ports	Applications	Hydraulic Symbol
<b>CVR3</b>	Pressure Relief Valve	3/8"-18NPTF	Controls pressure developed by the pump in hydraulic loop. By-pass occurs when preset pressure reaches 0-10,000 PSI. Turn clockwise to increase pressure, counter-clockwise to decrease.	
<b>CVR3/H</b>		3/8"-18NPTF	Same as CVR3, but return line hose / 1 meter length is included.	
<b>CVL3</b>	Manual Operated Check Valve	3/8"-18NPTF	Mounted in line with a cylinder and will hold pressure in the cylinder in the event of pressure loss in the system. Pressure is manually released.	
<b>CVLS3</b>		3/8"-18NPTF	Mounted in line with a cylinder which will hold pressure in the event of pressure loss in the system. Most often used on double-acting cylinders with pilot port, receiving pressure from a tee off of the cylinder retracting line. Pilot pressure ratio 15% or 6.5:1	



## FCV SERIES



**CMH6**

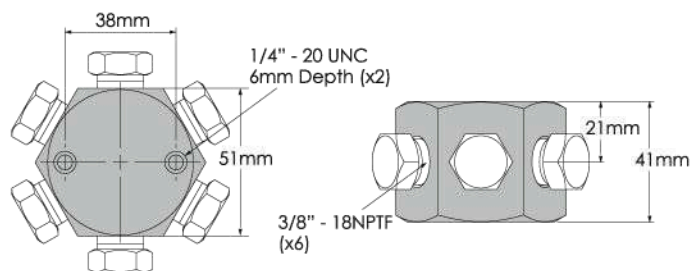

**CM7**

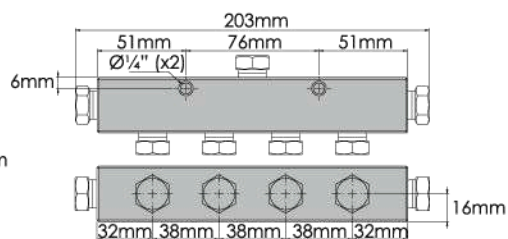
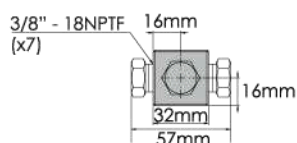

**CM14**

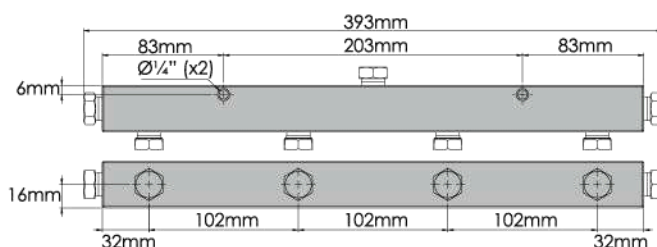

**MFC2**

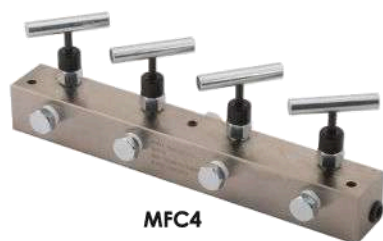
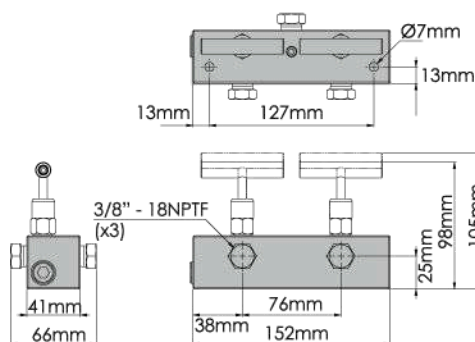

**MFC4**

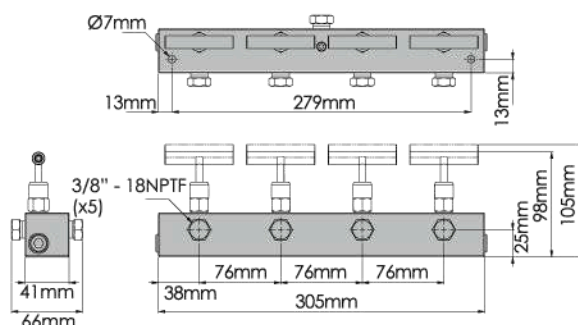

MODEL	Manifold Type	Number of Ports	Port Size	Mounting Holes
CMH6	6-Port Hexagon Manifold	6	3/8" - 18NPTF	1/4" - 20UNC
CM7	7" Long Manifold	7	3/8" - 18NPTF	1/4" - 20UNC
CM14	14" Long Manifold	7	3/8" - 18NPTF	1/4" - 20UNC
MFC2	Manifold with Two Needle Valves	2	3/8" - 18NPTF	0.28" Dia.
MFC4	Manifold with Four Needle Valves	4	3/8" - 18NPTF	0.28" Dia.